

1 MALE & FEMALE RESTROOM PLAN
A-4.01 SCALE 1:25 M.

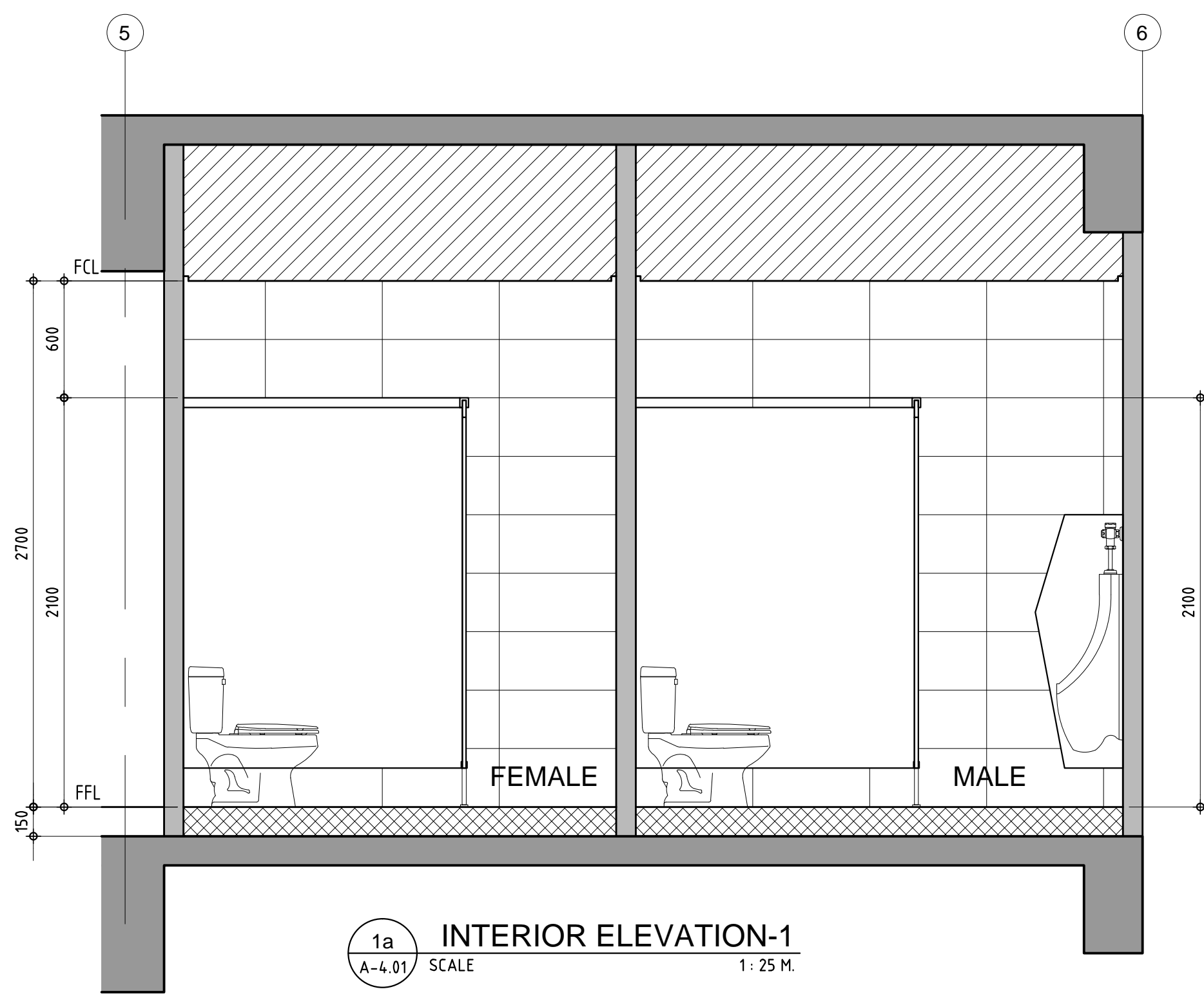

1a INTERIOR ELEVATION-1
A-4.01 SCALE 1:25 M.

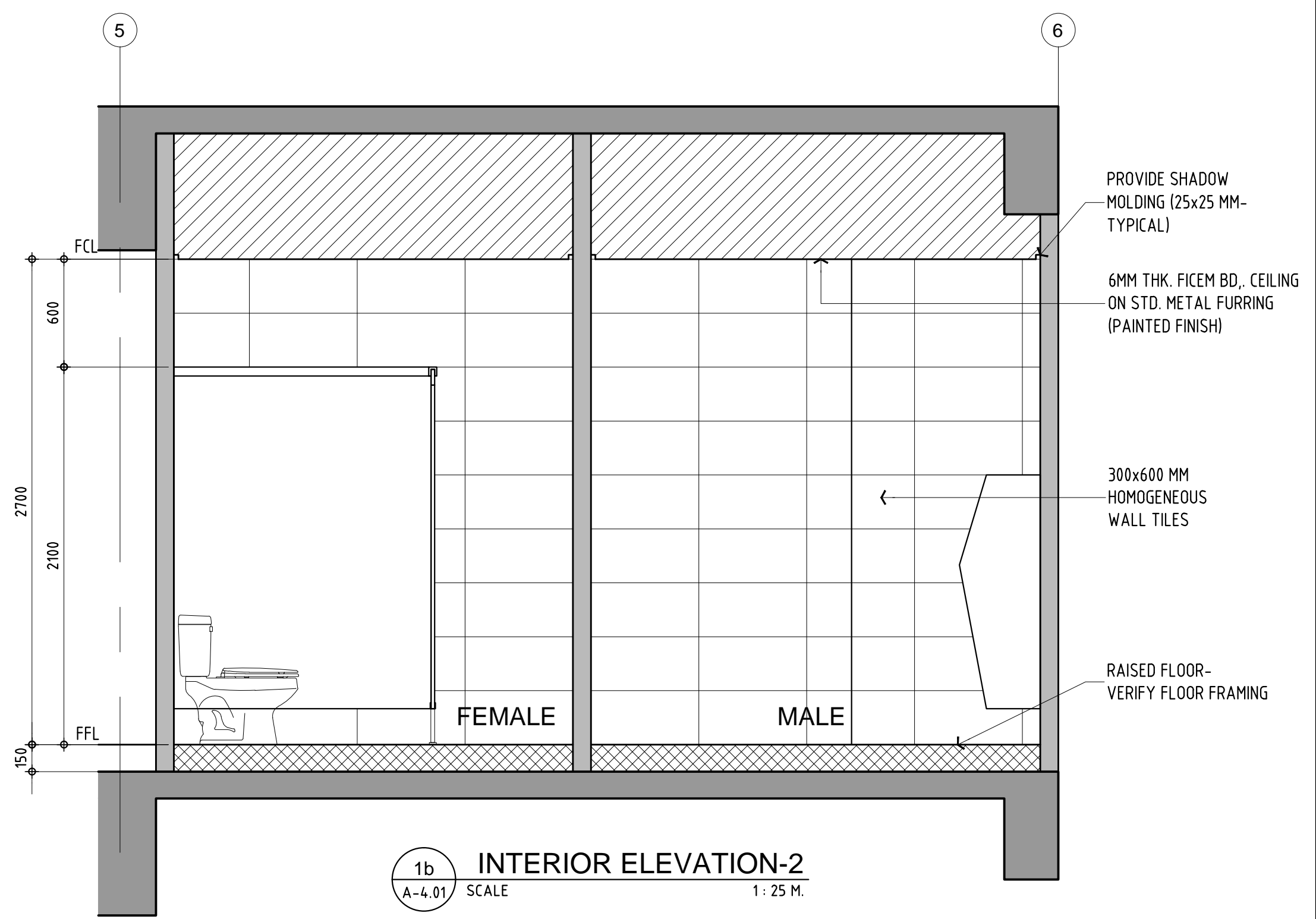

1b INTERIOR ELEVATION-2
A-4.01 SCALE 1:25 M.

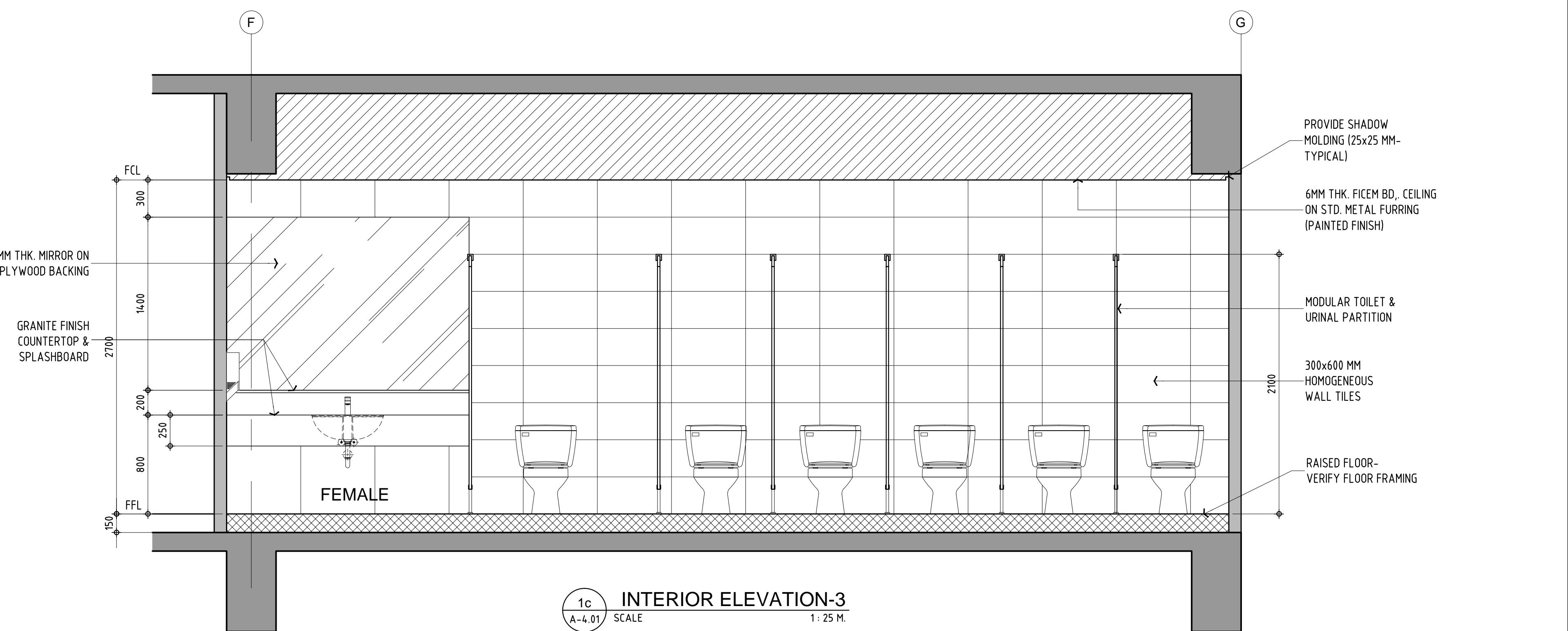

1c INTERIOR ELEVATION-3
A-4.01 SCALE 1:25 M.

NOTE:
ALL TOILETS SHALL BE RAISED FLOOR.

| | | | | | | | |
|--|--|------------------------------|--|---|--|------------------|-----------|
| | PROJECT & LOCATION | SHEET CONTENTS : | SUBMITTED BY: | DESIGNED BY: | APPROVED BY: | PROJ. NO. | SHEET NO. |
| | PROPOSED DANGEROUS DRUGS BOARD EXTENSION OFFICE SOUTH INSULA CONDOMINIUM COMPLEX, TIMOG AVE., DILIMAN, SOUTH TRIANGLE, QUEZON CITY | MALE & FEMALE TOILET DETAILS | VICTOR S. ADRIANO CIVIL ENGINEERING CONSULTANCY SERVICES VICTOR S. ADRIANO PRC 18502 PRESIDENT/GEN. MANAGER | JUAN CARLO S. GERVASIO II ARCHITECT PRC - 17811 PTR - 7363158 01-16-19 MAKATI CITY | EARL P. SAAVEDRA MPA 9 - EXECUTIVE DIRECTOR DATE: | GA 2019 08 | A-4.01 |